

3 in 1 Air Compressor Pump Voltage

 Risk of electrical shock. Perform tests at your own risk.

1. Make Sure Main Breaker and Compressor Breakers are on before testing

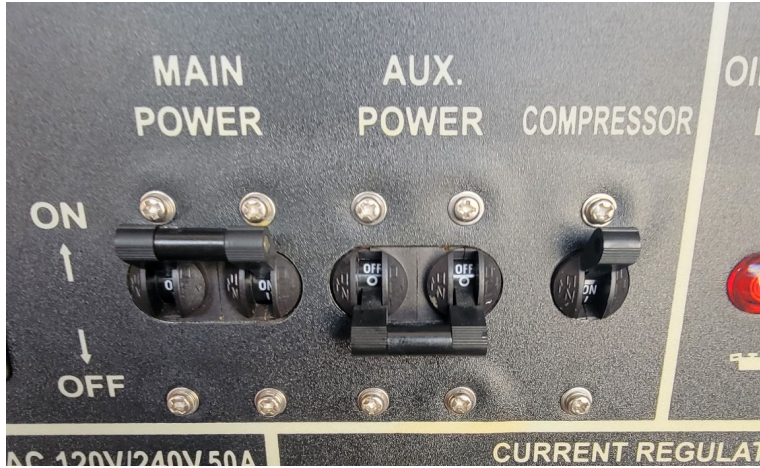

Voltage Diagram

Locking side up with empty pin on top left

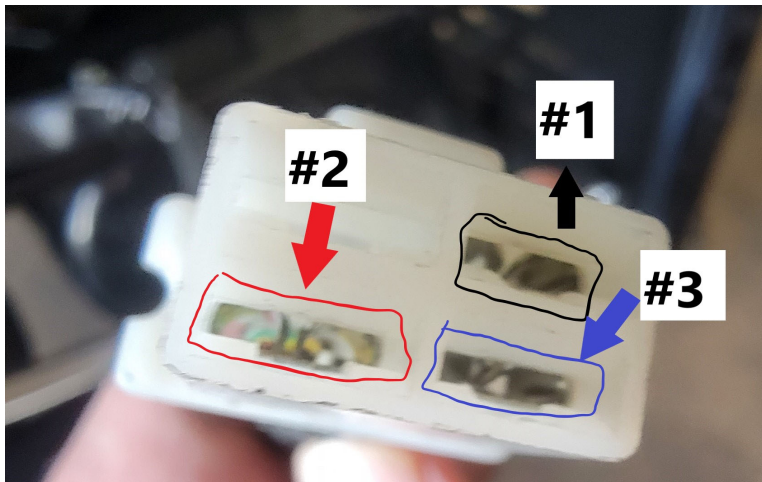

#	#	Voltage
Pin #1	Pin #2	169 Volts
Pin #1	Pin #3	235 Volts
Pin #2	Pin #3	60 Volts